

stacked books
libros apilados

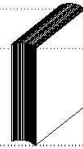

book
libro

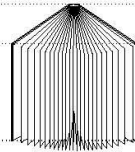

open pages
hojas abiertas

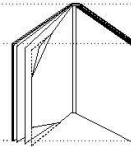

folding
plegado

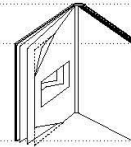

carving
horadar

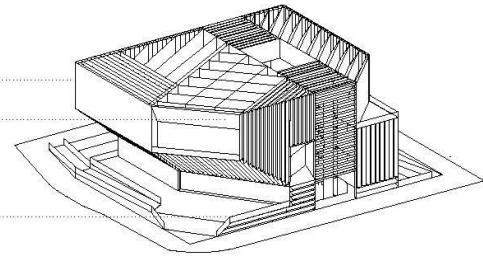

library, archive & nursery school
biblioteca, archivo y escuela infantil

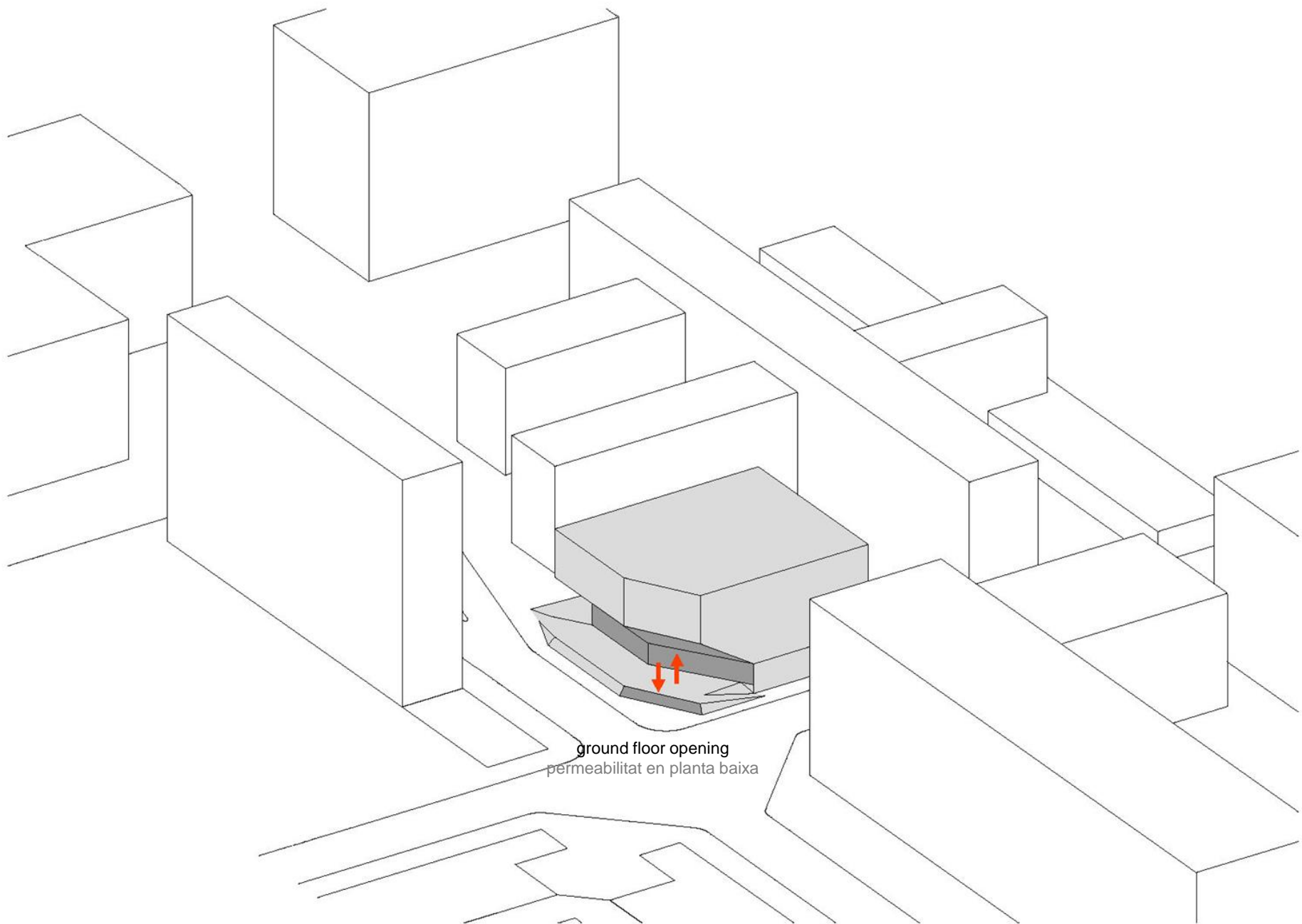

ground floor opening
permeabilitat en planta baixa

public space expansion . ampliació d'espai públic . ampliación del espacio público

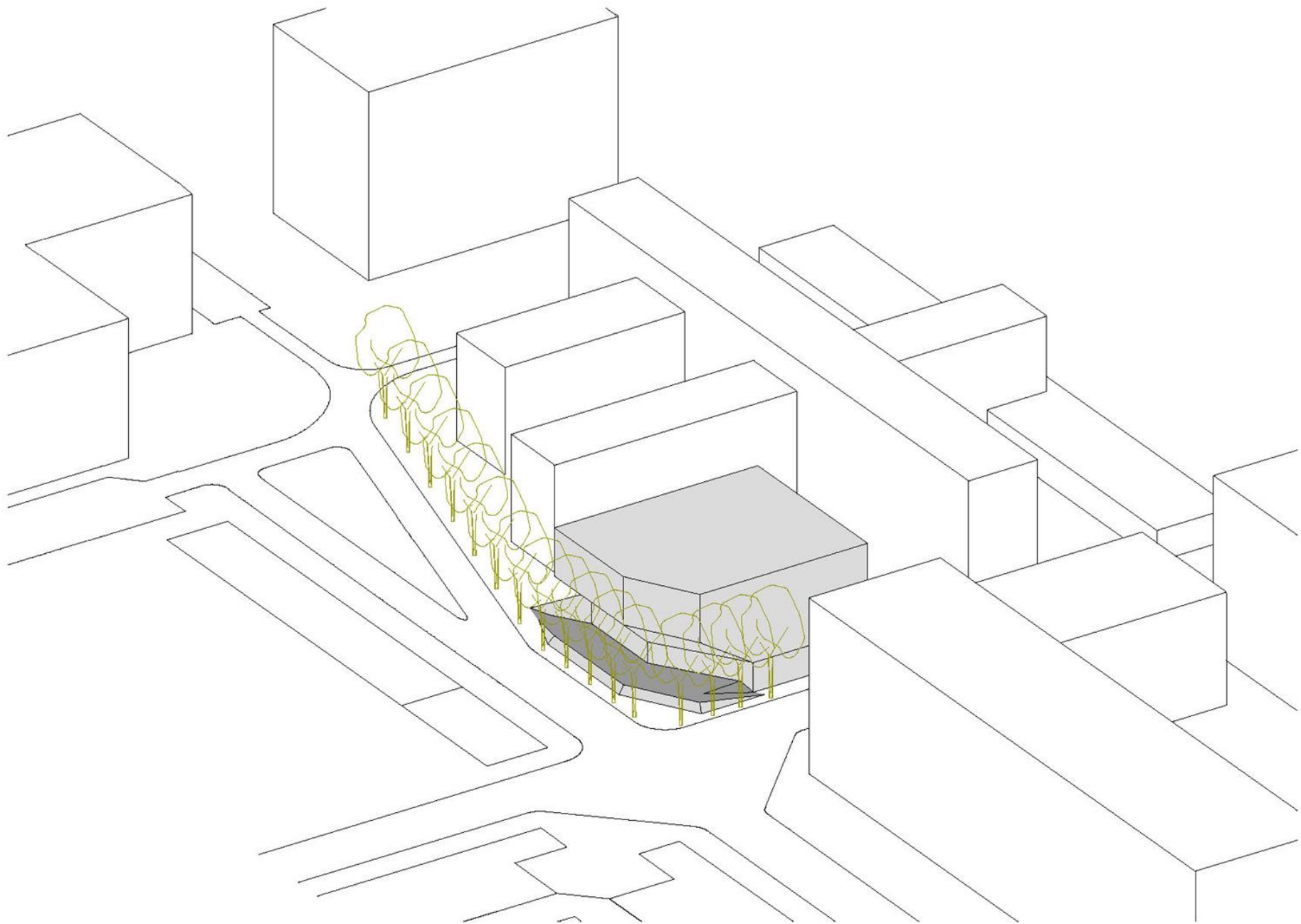

trees arcade . arquería d'arbres . arcada de árboles

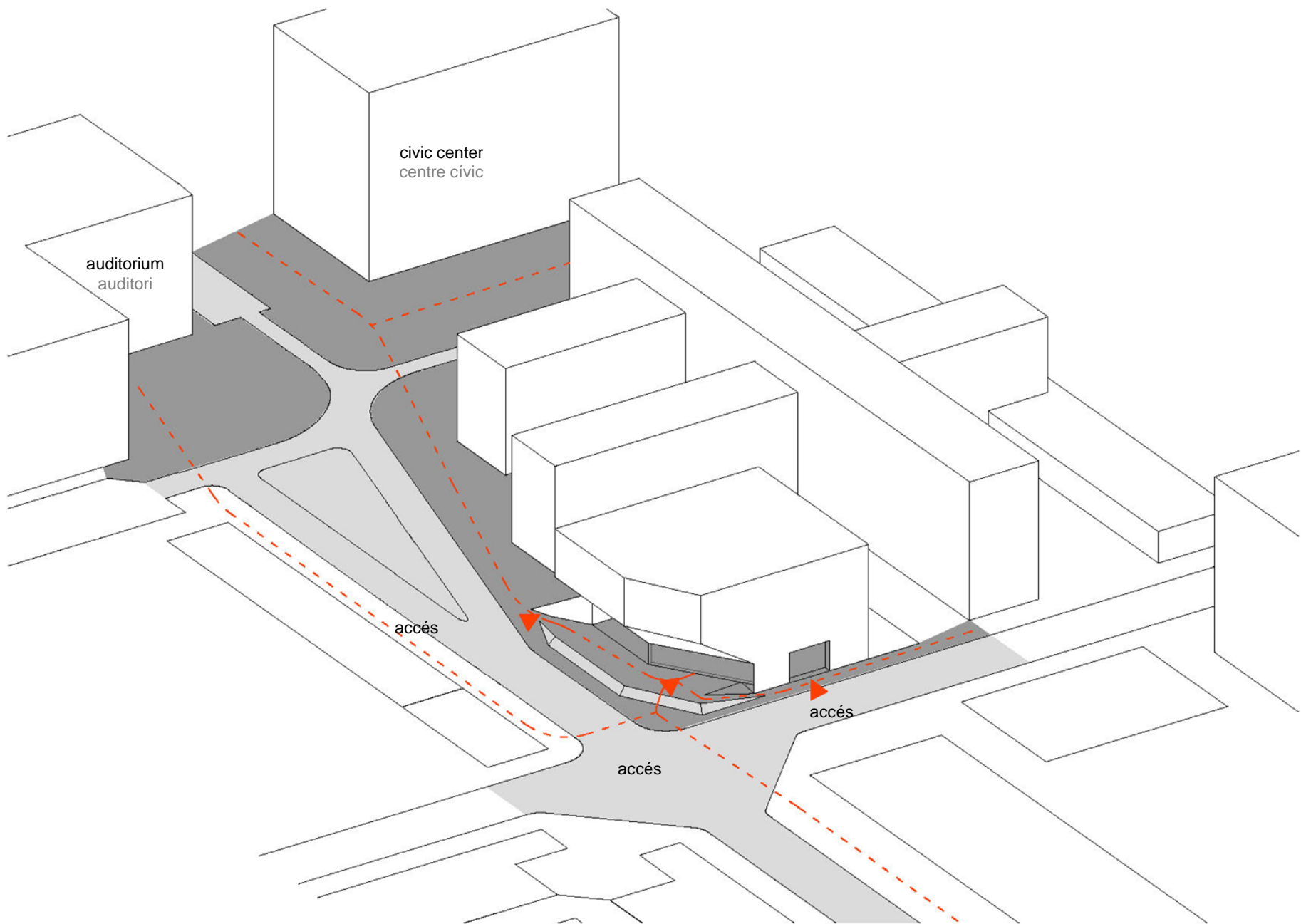

independent accesses . accessos independents . accesos independientes

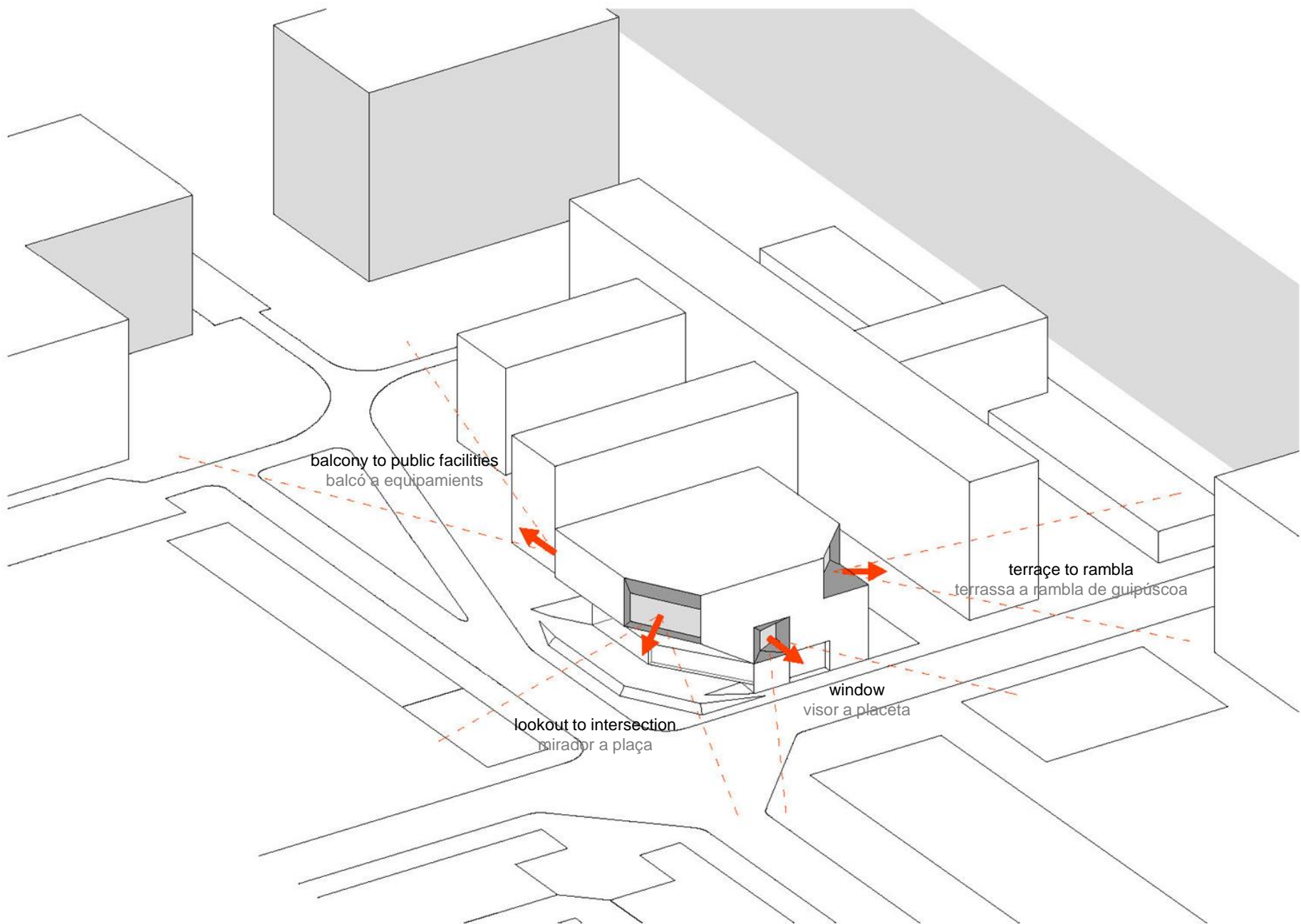

planta de cubierta
roof floor

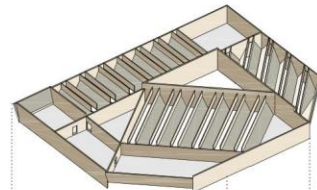

planta tercera
third floor



planta segunda
second floor

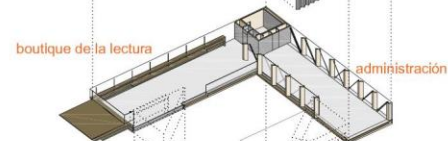

planta primera
first floor

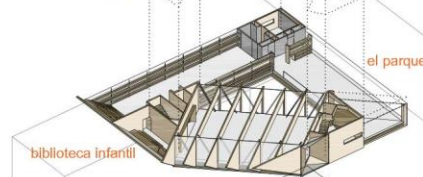

planta baja
ground floor



planta inferior
lower floor

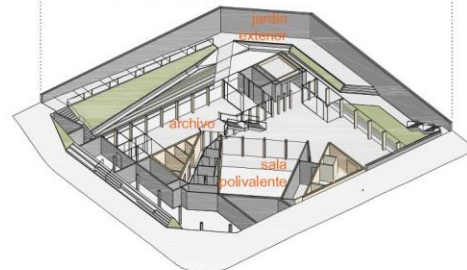

nº plantas: 6
superficie: 4.000 m2c
presupuesto obra:
10.550.000€ PCA (IVA incl.)





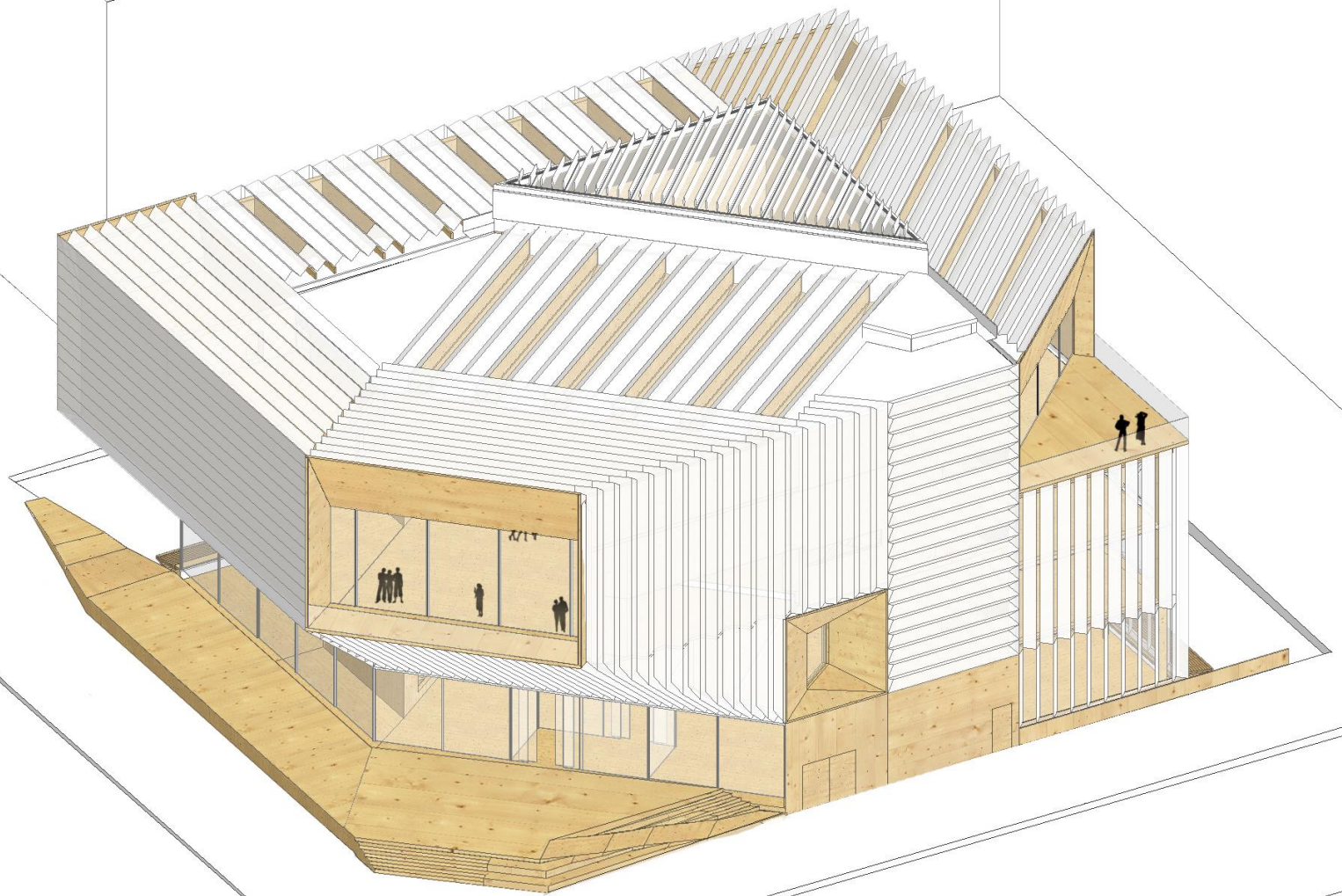

envolvente. envelope

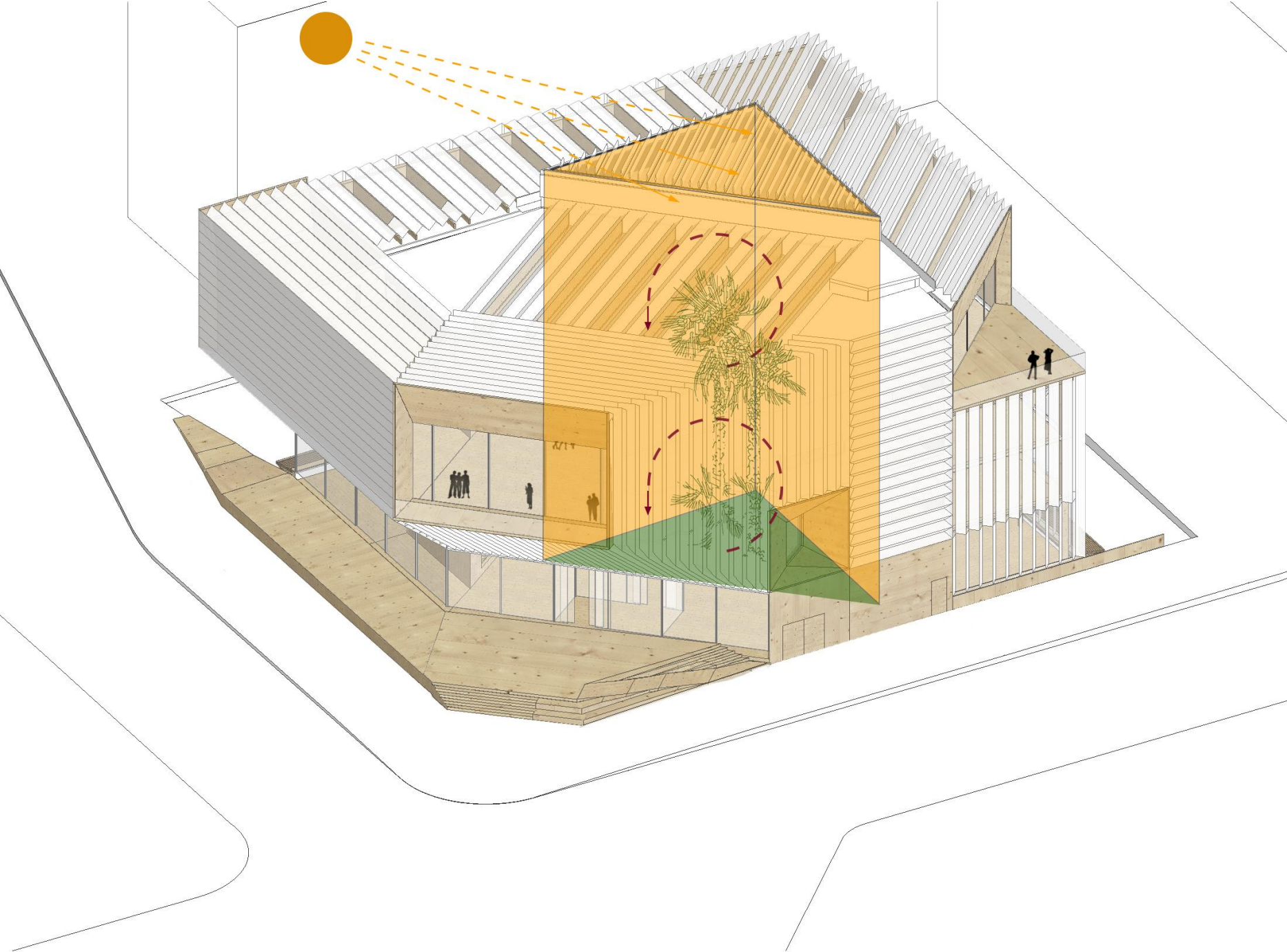

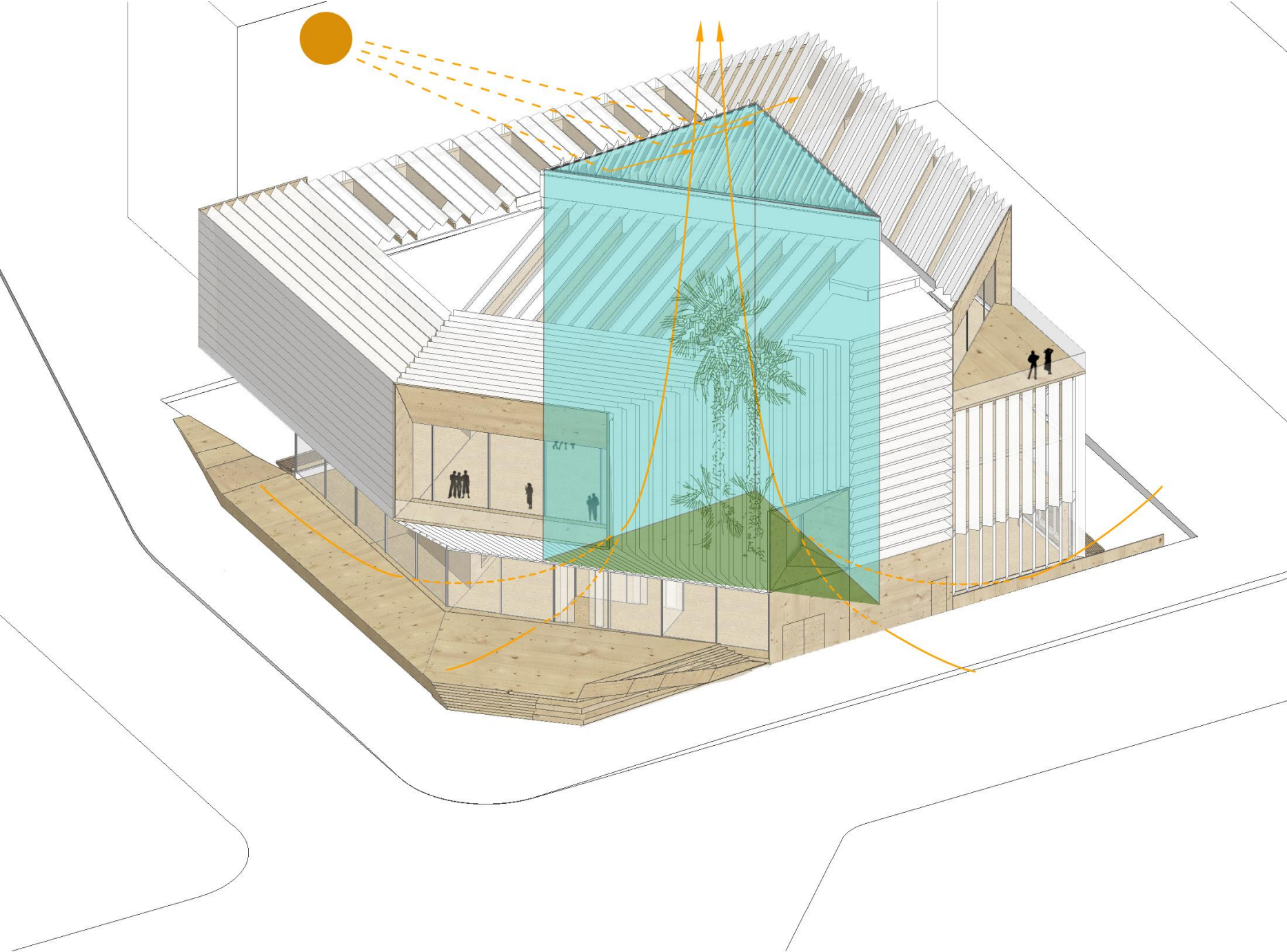

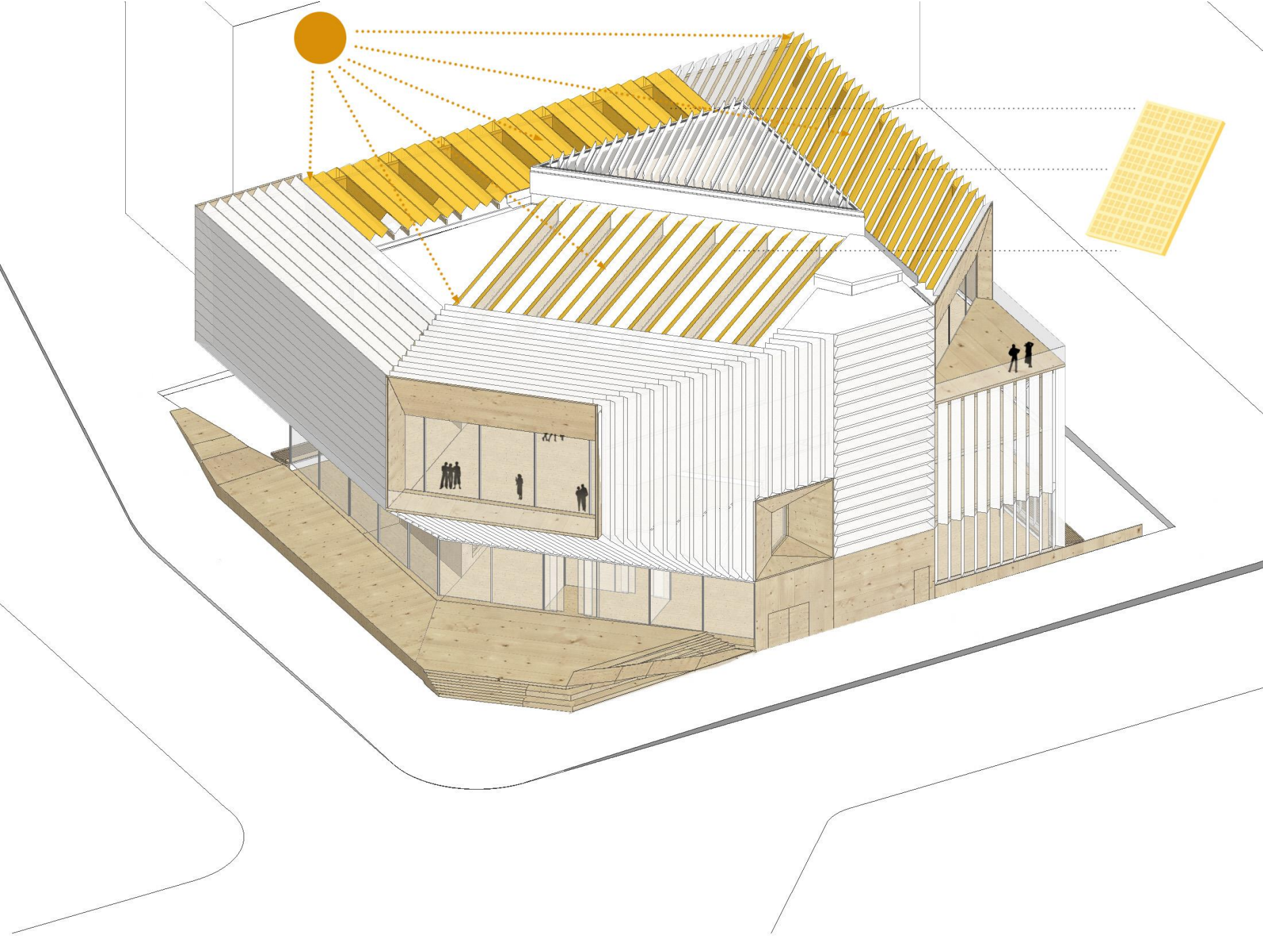

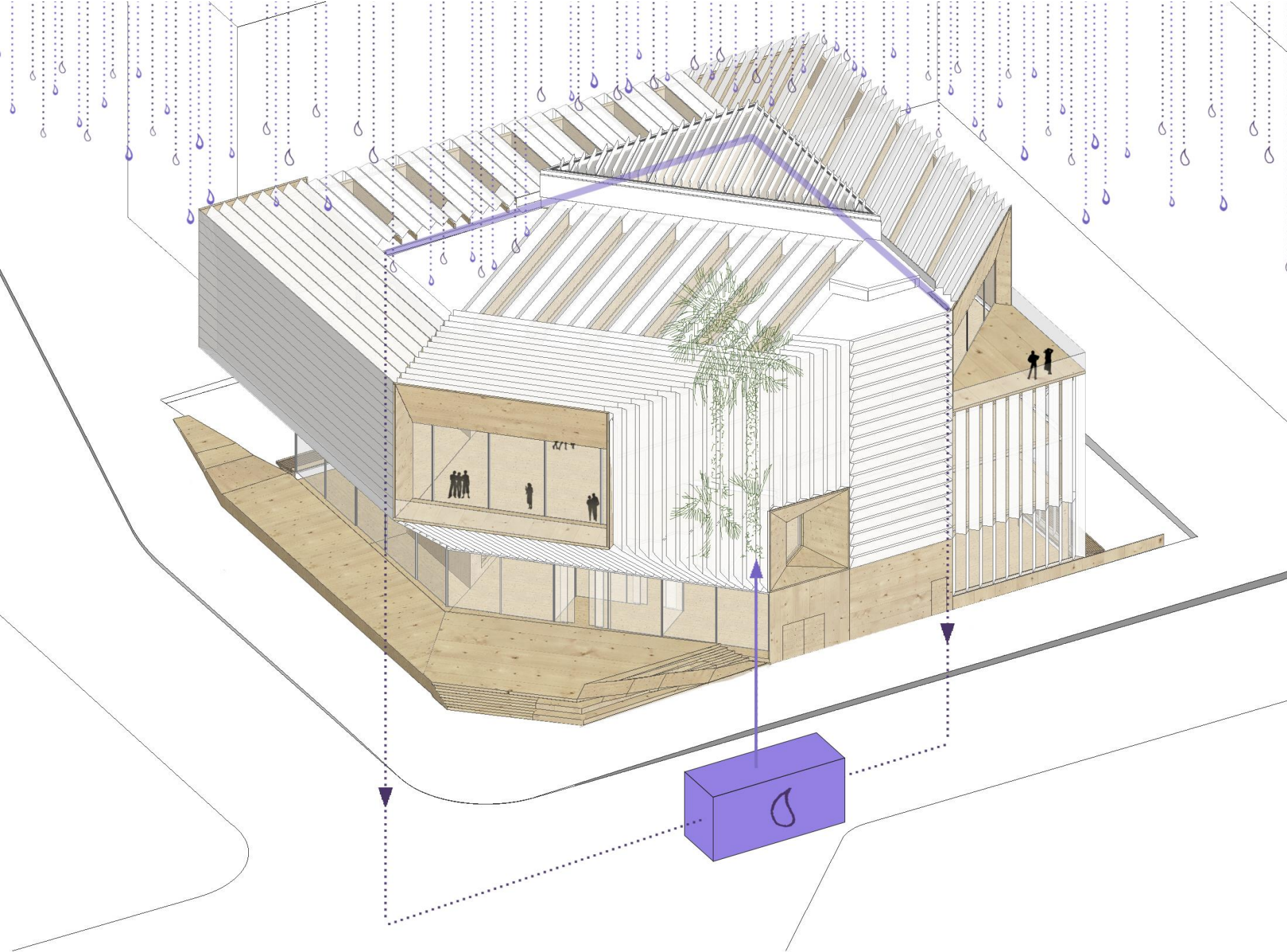



CARBON LCA

Project Name / Number	13662	
Date	23.09.2020	
Country of construction	Spain	
Volume of KLH® - CLT elements	1202	[m³]
Transport by Truck	1577	[km]
Ship	0	[nm]

This project produces a total of (A1-A5)	406.2	tons CO ₂ equ.
This project stores a total of (CO ₂ wood)	-954.6	tons CO ₂ equ.

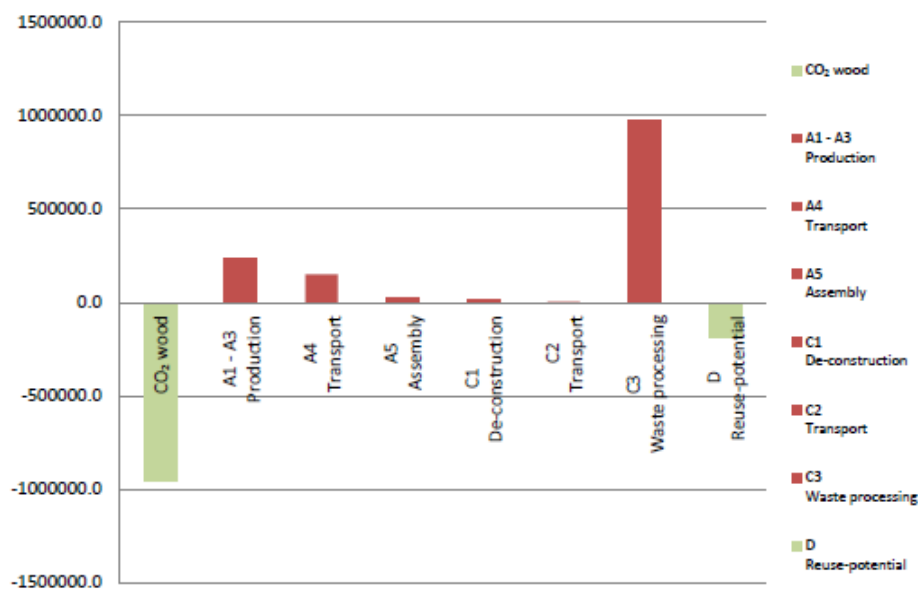

By the End of Life (all stages) with the substitution (D) of KLH® - CLT as thermal energy (incineration) a total of **244.8** tons CO₂ equ. would be released for this project.

Regrow time (in Austrian forests, considering actual sawn timber)	41.3	minutes
---	------	---------

CARBON LCA

Project Name / Number	13662 glulam
Date	24.09.2020
Country of construction	Spain
Volume of glulam elements	85 [m³]
Transport by Truck	1050 [km]
Ship	0 [nm]

This project produces a total of (A1-A5)	25.2	tons CO ₂ equ.
This project stores a total of (CO ₂ wood)	-67.5	tons CO ₂ equ.

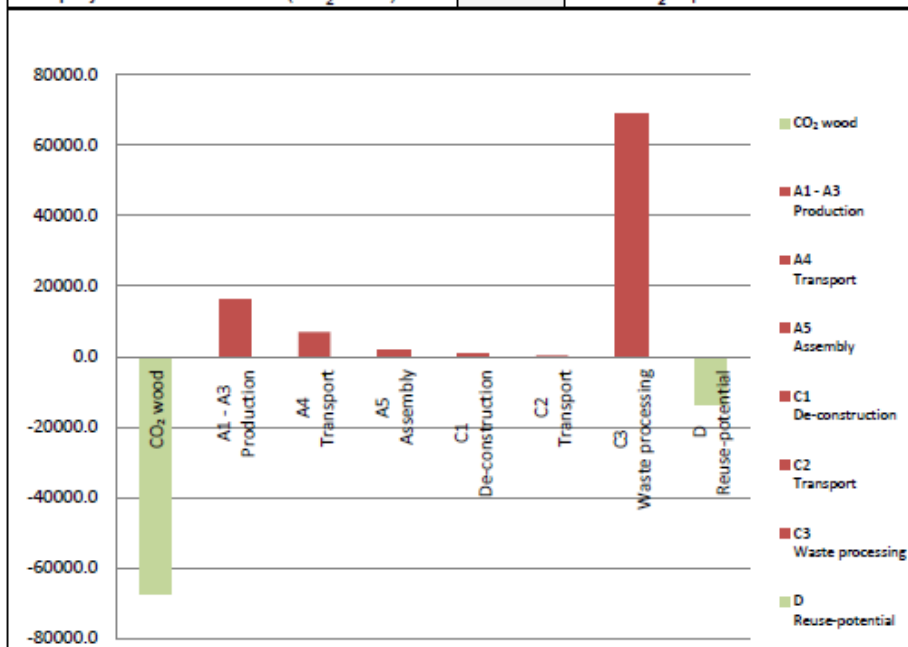

By the End of Life (all stages) with the substitution (D) of glulam as thermal energy (incineration) a total of **13.8** tons CO₂ equ. would be released for this project.

Regrow time (in Austrian forests, considering actual sawn timber)	2.9	minutes
---	-----	---------





Fotografía: Jesús Granada



Fotografía: Jesús Granada



Fotografía: Jesús Granada





Fotografía: Jesús Granada











Fotografía: Jesús Granada

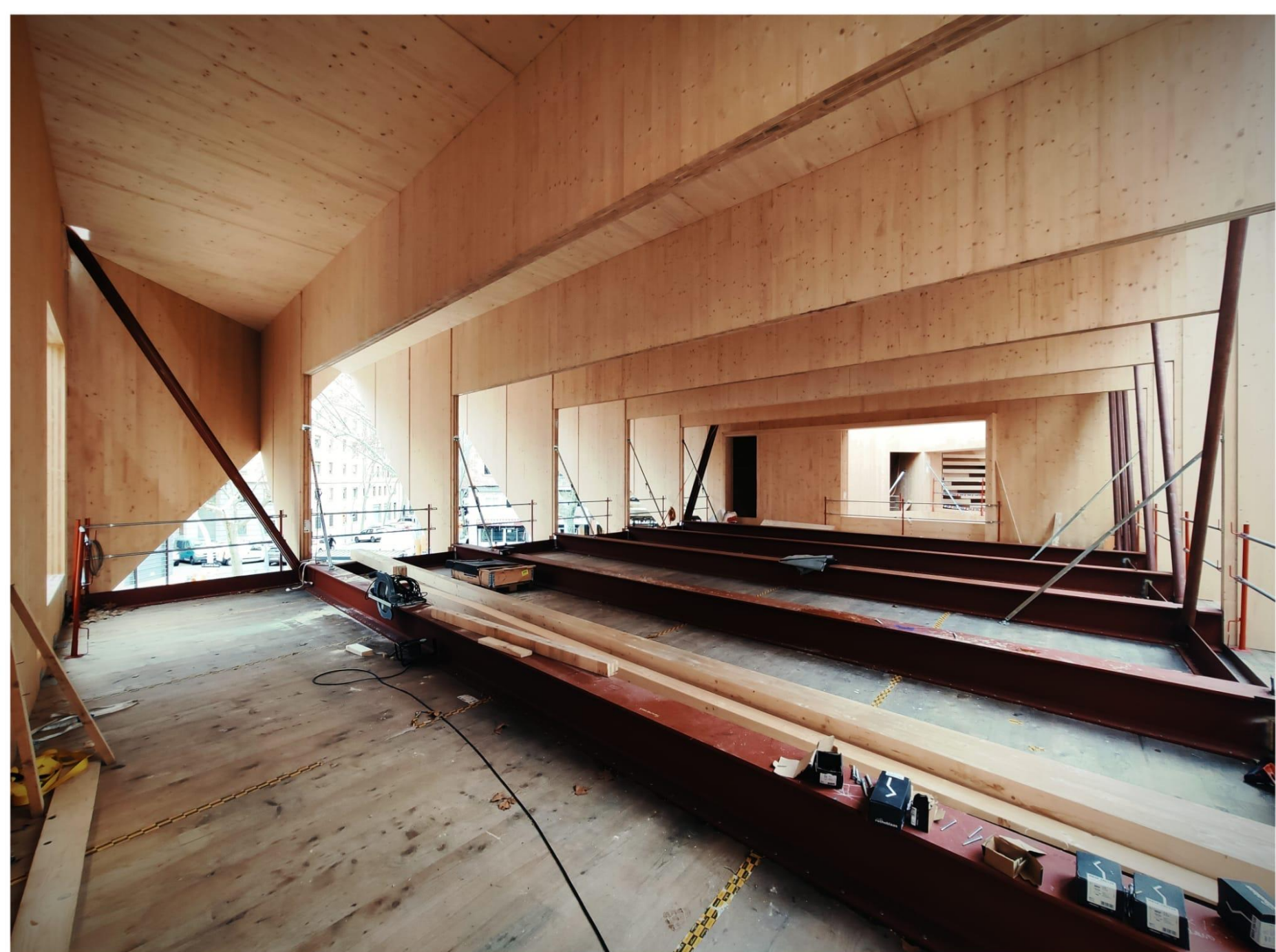











Fotografía: Jesús Granada



Fotografía: Jesús Granada



